

**INSTRUCTION FOR USE**

**SONIC ELECTRIC SILICONE TOOTHBRUSH**

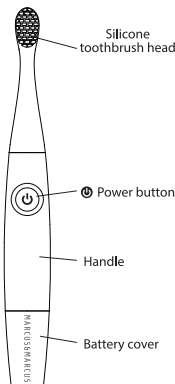

**INTERACTIVE LCD BRUSHING TIMER**

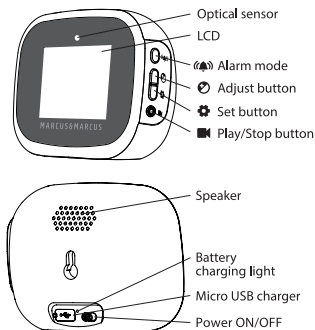

**SONIC ELECTRIC SILICONE TOOTHBRUSH**

**How To Place Battery To Sonic Electric Silicone Toothbrush**

1. Turn battery cover as direction (1) and pull down as (2).
2. Insert a new AAA alkaline battery with (-) and (+) in correct orientation.
3. Install battery cover as (3) and turn it firmly as (4).

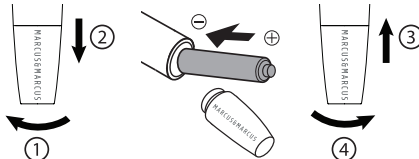

**How To Insert Silicone Toothbrush Head Into The Sonic Electric Silicone Toothbrush**

1. Plug the new silicone toothbrush head into the notch and twist clockwise until the toothbrush head is secured. Wash toothbrush head thoroughly with warm-soapy water before initial use.
2. To replace the old toothbrush, twist the old toothbrush head anti-clockwise and pull it off.

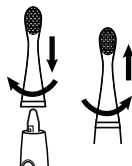

**CLEANING & CARE:**

- Wash silicone toothbrush head thoroughly with warm-soapy water before initial use. After use, rinse toothbrush head thoroughly, shake off excess water and store upright. Allow air dry.
- Do not immerse the toothbrush under water.
- Do not strike or knock the toothbrush with too much strength.
- Do not use any other toothbrush heads other than that recommended by the manufacturer.
- Make sure the battery cover is fixed firmly when washing the toothbrush.
- Take out battery of toothbrush and switch the LCD Brushing Timer to power OFF if no intention to use for an extended period of time.
- The LCD Brushing Timer is not water proof. Check and make sure no water on the Brushing Timer. Wipes it dry if necessary. Otherwise, it may cause malfunction.
- Store products in a dry place. Do not leave products in direct sunlight or near a source of heat.

**FOR YOUR CHILD'S SAFETY AND HEALTH**

**WARNING!**

- This is not a toy. This product is for tooth brushing only.
- Not suitable for children under 3. Always use with adult supervision.
- Do not leave child unattended while using the product.
- Keep away from children when not in use.
- Inspect the product before each use.
- Do not chew or bite on toothbrush. Battery choke hazard.
- Do not install batteries backwards, charge or put in fire. May explode or leak causing injury.
- Always use AAA alkaline batteries. Use of non-alkaline batteries may result in a drastically reduced operating time.
- If battery cover is not secured, water leakage may cause malfunction of the toothbrush.
- Dentists recommend to replace silicone toothbrush head every 6 months or sooner if it looks worn.
- If your kid is undergoing treatment for any oral condition or experiences any discomfort, consult your dental professional prior to use.
- Discard and replace at first signs of damage or weakness.

**SPECIFICATION**

**Sonic Electric Silicone Toothbrush**

Operation voltage: 1.5V DC  
 Battery: AAA Alkaline battery 1PX7  
 Sonic vibration: Frequency 7000 oscillations/ min

**Interactive LCD Brushing Timer**

Operation voltage: 3.7V DC  
 Battery: Rechargeable Lithium battery (built-in)  
 Charging voltage: 5V DC

**INTERACTIVE LCD BRUSHING TIMER**

**How To Charge Up The Interactive LCD Brushing Timer**

1. Insert the micro USB plug from a 5V USB power adapter (not included) and the light at the back of the LCD Brushing Timer shows the battery is charging.
2. Charge the LCD Brushing Timer for 4 hours or switch to power ON for battery indication. Disconnect charger when on the screen stops flashing and in full.

**How To Set Clock On Interactive LCD Brushing Timer**

1. Switch the LCD Brushing Timer to power ON.
2. Press , then press to adjust hour.
3. Press , then press to adjust minute.
4. Press once finished.

**How To Set Alarm Clock On Interactive LCD Brushing Timer**

1. Switch the LCD Brushing Timer to power ON.
2. Press for 3 secs until is flashing on the screen, use to adjust hour.  
Press to confirm.
3. Use to adjust minute and press to confirm.
4. Simply press once to turn on the alarm if the time is set.
5. Press to turn off the alarm.

**How To Use Sonic Electric Silicone Toothbrush & Interactive LCD Brushing Timer**

1. Switch the LCD Brushing Timer to power ON.
2. LCD Brushing Timer will be activated when someone moves in front of the optical sensor or change of light.
3. Apply toothpaste to the silicone toothbrush head before pressing on the toothbrush.
4. Once press , it will transmit a RF signal to the LCD Brushing Timer.
5. LCD Brushing Timer can receive RF signal within 5 meters range.
6. LCD Brushing Timer will start one of the 3 animations at the same time to encourage kids to brush for 2 minutes.  
If is pressed before the 2-minute completion, the screen will show a message of "Try Harder Next Time!"
7. You can play or stop animation by pressing during screen is ON.
8. When the vibration of the toothbrush is gradually weakened indicating that the battery is almost drained, replace it by a new AAA alkaline battery. Before replacing the battery, ensure the handle is thoroughly dry to prevent water drops entering it.
9. The LCD Brushing Timer will be reset when switch to power OFF.